

V&A

**CORPORATE &
PRIVATE EVENTS**

CONTACT

+44 (0)20 7942 2888

corporateevents@vam.ac.uk



CORPORATE AND PRIVATE EVENTS AT THE V&A

Reflecting its reputation as the world's greatest museum of art and design, the V&A's magnificent South Kensington building is itself a unique gem of Victorian architecture. A treasure house teeming with collections of fabulous scope and diversity, the Museum boasts extraordinary rooms and spaces which offer exceptional possibilities for entertaining in a prestigious central London location.

It is also possible to hold an exclusive viewing of an exhibition during evening events.

The V&A is also a unique venue for filming and location hire. An exciting variety of venues are listed below, with information about each space to help you select the appropriate location for your event.

Contents

- Venues 2
- Filming and Location hire 18
- Capacities 19
- Price List 20
- Approved Caterers 21
- Approved Contractors 22
- Contact Information 24



THE DOME

The Dome, with its soaring ceiling, classical architecture and marble floors, all complemented by Dale Chihuly's extraordinary blue and green glass sculpture, provides a spectacular backdrop for receptions. The glass information desk can be used as a cocktail bar.

Essential information
Reception 600 guests

Hire fee

Reception from £8,000



THE DOME

The Dome is one of London's most elegant and impressive settings for receptions, dinners and dinner-dances.

Essential information

Seated dinner 250 guests

Dinner-dance 250 guests

Hire fee

Dinner from £11,000

Dinner-dance from £13,000

A pre-dinner drinks reception can be held in the Dorothy and Michael Hintze Sculpture Galleries or John Madejski Garden Please note that a dancefloor must be hired when organising a dinner-dance.



THE MEDIEVAL & RENAISSANCE GALLERIES

Over ten years in the planning, two years in the building and showcasing the world's largest collection from the period, the V&A's Medieval & Renaissance Galleries opened in 2009 to great critical acclaim.

The ten new galleries include The Paul and Jill Ruddock Gallery. This gallery is conveniently located next to the Dome and is a stunning space for receptions, pre-dinner drinks and dinners.

Large scale works, once part of impressive Renaissance buildings are displayed in the context of a cityscape. Dramatic sculptures by Giambologna and others stand in a setting evocative of a courtyard and garden. The choir screen from the Cathedral of St John at 's-Hertogenbosch in the Netherlands, one of the largest objects on show, provides a powerful backdrop for events.

Essential information

Reception 300 guests

Dinner 80 guests

Hire Fee

Reception from £8,500

Dinner from £11,000

Due to the nature of the objects on display, it is not possible to serve red wine in this gallery.



THE DOROTHY AND MICHAEL HINTZE SCULPTURE GALLERIES

The Dorothy and Michael Hintze Sculpture Galleries display some of the V&A's finest sculpture and provide a stunning setting for receptions and pre-dinner drinks. The black and white mosaic flooring enhances the collection and tall windows open out onto the John Madejski Garden.

The galleries are situated close to the Museum's major exhibition halls and provide an ideal space for drinks receptions and dinners for up to 60 people on one long table.

Essential information

Reception 300 guests

Pre-dinner drinks 300 guests

Dinner 100 guests

Hire fee

Reception from £8,000

Dinner from £11,000

Due to the nature of the objects on display, it is not possible to serve red wine in this gallery.



THE JOHN MADEJSKI GARDEN

The V&A's garden and is one of the most elegant outdoor venues in London.

The John Madejski Garden is a tranquil space featuring a paved ellipse with water jets between steps, which are illuminated at night. The design allows the beautiful 19th-century terracotta facades to be more visible and provides flexibility to transform the space for different types of events. The garden is one of London's hidden treasures, and is particularly magical when lit.

Essential information

Reception 600 guests

Pre-dinner drinks 400 guests

Hire fee

From £8,000

Marquees are not permitted in the garden. The Dome provides an alternative venue in case of rain and is included in the venue hire. Smoking is only permitted in the garden.



Image courtesy of Edward Hill Photography

RAPHAEL GALLERY

Our largest and most prestigious space, the Raphael Gallery houses some of the most important surviving examples of Renaissance art in the world. The seven Raphael cartoons, dating back to 1516, are complemented by a gilded Spanish altarpiece lending a striking backdrop to drinks receptions, dinners, concerts and awards presentations.

Essential information

Reception 400 guests

Dinner 400 guests

Concert 300 guests

Hire fee

From £10,000

Clients are welcome to use the Dorothy and Michael Hintze Sculpture Galleries, John Madejski Garden or Dome for pre-dinner drinks, depending upon the number of guests.

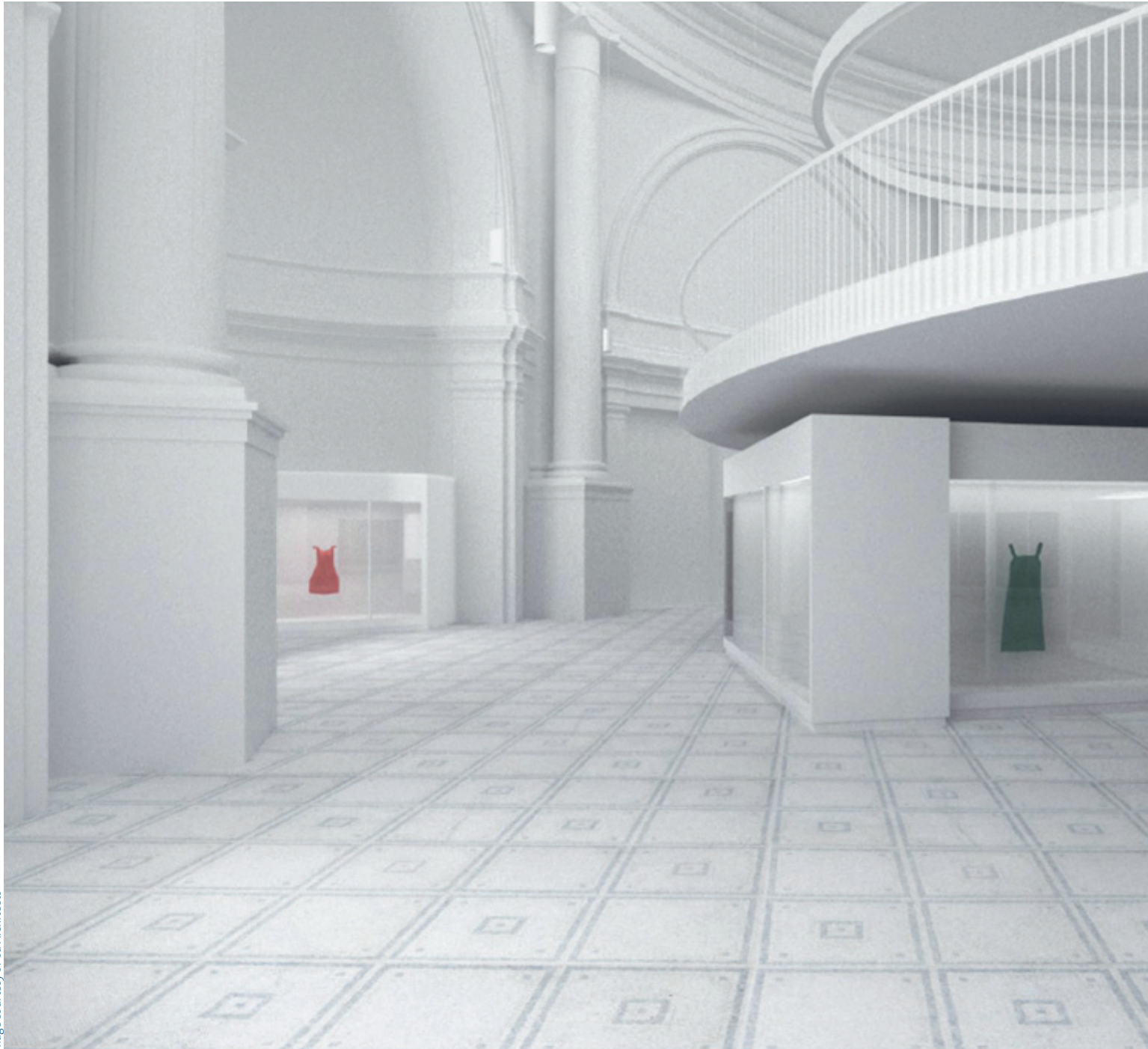

Image courtesy of 6a Architects

FASHION GALLERIES

The Fashion Galleries re-open in spring 2012 and will host a series of stunning temporary fashion exhibitions. The dress collection covers four centuries of European fashionable dress, from the beginning of the 18th century to the latest creations of the 21st century, and from the ornate richness of a court mantua to the minimalism of contemporary couture.

The Fashion Galleries are new venues for hire, as entertaining in these spaces has not been possible in the past.

Essential information

Reception 300 guests

Pre-dinner drinks 300 guests

Hire fee

From £8,500

Due to the nature of the objects on display, it is not possible to serve red wine in this gallery.



THE EDWIN AND SUSAN DAVIES PAINTINGS GALLERIES

A suite of five galleries displaying 200 works from the V&A's extensive paintings collection is available for drinks receptions. The collection includes paintings by Constable, Turner and Gainsborough, and famous works by Blake, Landseer and Millais.

Essential information
Reception 200 guests

Hire fee
From £7,000

Due to the delicate nature of the objects, red wine and hot canapés are not permitted in this gallery.



THE WHITELEY SILVER GALLERIES

The spectacular Whiteley Silver Galleries house the nation's finest collection of silver, with over 1500 objects on view.

The galleries, which overlook the John Madejski Garden, are a superb example of Victorian decoration and ornamentation, providing a unique, glittering space for evening receptions.

Essential Information

Reception 250 guests

Hire fee

From £7,000



THE LYDIA AND MANFRED GORVY LECTURE THEATRE

Reached via the ornate ceramic staircase and the Whiteley Silver Galleries, this magnificent Victorian auditorium is an unusual venue for imaginative presentations.

Raked tiers of fixed theatre-style seating for 300 people lead down to a 12-metre stage, above which is a lavishly decorated ceiling. Seating is bench type, with a continuous seat cushion per row.

Essential information

Seats 300 guests

Hire fee

Full day £4,000

Half day £2,000

Evening hourly rate £4,000

Other details

Please note there are no facilities available for serving refreshments or lunch when using the Lecture Theatre.



THE MORRIS AND GAMBLE ROOMS

These unique venues are available for breakfast events, which can be followed by an exhibition private view before the general public arrive at 10am.

The Gamble Room is beautifully tiled with ceramics by Maw and Minton, and the windows feature stained glass incorporating the Royal Arms.

The adjacent Morris Room is a classic example of William Morris's early domestic decorative style and was completed in 1868. The décor follows the Elizabethan Revival style favoured by the Pre-Raphaelites with painted panels and stained glass windows by Sir Edward Burne-Jones.

Essential Information

Morris Room 40 guests

Gamble Room 100 guests

Hire Fee

Morris Room £2,000

Gamble Room £2,500

There is a supplement for an exhibition private viewing.

THE SACKLER CENTRE

The Sackler Centre is the V&A's space for arts education. The Centre's contemporary, dynamic and minimalist interior is in contrast to the rest of the V&A.

This innovative space is available for daytime and evening hire and includes:

- The Hochhauser Auditorium
- Seminar Room 1
- Seminar Room 2
- Sackler Centre foyer





THE HOCHHAUSER AUDITORIUM

This multi-purpose auditorium is the Sackler Centre's lecture theatre equipped with large leather chairs, a big screen and sprung floors.

Essential information

Seats 140 guests

Other details

The first three rows of seating can be removed to provide space for 5–6 wheelchair users.

An afternoon lecture can be followed by an evening reception in the Sackler Centre lobbies. Other facilities include DVD playback, data projection and hearing induction loops. Furniture for panel discussions can be supplied on request. AV support can be provided at an additional cost.

Hire fee

Full day £3,000

Half day £1,700

Evening hire from £4,000



SEMINAR ROOM 1

Seminar Room 1 is one of two rooms available for daytime hire in the Sackler Centre. It is soundproofed and is ideal for discussions and meetings.

Essential information

Seated 60 guests

Hire fee

Full day £2,000

Half day £1,200

Evening hire from £3,000

Other details

Facilities include data projection and DVD playback.



SEMINAR ROOM 2

With its high ceilings and natural light flooding in, Seminar Room 2 is an ideal space for team away-days. Situated next to the Hochhauser Auditorium, it can also serve as a small break-out space.

Essential information

Seated 20 guests

Standing 40 guests

Hire fee

Full day £800

Half day £500

Other details

A plasma screen for data projection is available.



SACKLER CENTRE FOYER

The Sackler Centre provides a light and airy space for an evening reception.

Essential information

Reception 150 guests

Other details

For logistical reasons catering is arranged with the V&A's in-house caterer, Benugo.

Hire fee

From £4,000



FILMING AND PHOTOSHOOTS

The V&A offers a unique setting for filming and photoshoots, with impressive galleries, staircases, period rooms and a landscaped garden. We welcome enquiries for feature films, television documentaries, interviews and commercials. Recent productions include Hugo, The Oxford Murders, Franklyn, Spooks, New Tricks, Celebrity Come Dine With Me and Bargain Hunt.

The V&A also regularly accommodates photographic shoots and most recently has provided a location for Vanity Fair, the Telegraph Magazine and Topman.

We can accommodate film crews outside the V&A's opening hours (pre 10.00, post 17.45, except Fridays). For some locations we may be able to arrange a day-time slot. Please give as much notice as possible for filming, at least five working days.

Filming is also available at an alternative V&A site in Olympia. Originally the headquarters to the Post Office Savings Bank, this Victorian building offers an imposing façade, courtyard, spiral staircase and a rooftop with views over West London. It recently played host the highly acclaimed Tinker Tailor Soldier Spy.

For further information and a filming pack please contact Rachel Lloyd: r.lloyd@vam.ac.uk / 020 7942 2841.

CAPACITIES

	Drinks Reception	Dinner	Dinner-Dance	Seminar	Breakfast	Availability day/eve
Raphael Gallery	400	400				eve
Medieval & Renaissance Gallery	300	80				eve
Dome	600	250	250			eve
John Madejski Garden	600					eve
Dorothy & Michael Hintze Sculpture Galleries	300	100				eve
Whiteley Silver Gallery	250					eve
Edwin and Susan Davies Paintings Galleries	200					eve
Fashion Galleries	300					eve
Lydia and Manfred Gorvy Lecture Theatre				300		day/eve
Morris and Gamble Rooms					40/100	day
Sackler Centre for Arts Education						
• Hochhauser Auditorium	140					day/eve
• Seminar Room 1				60		day/eve
• Seminar Room 2				20		day/eve
• Sackler Centre Foyer	200					eve

PRICE LIST

THE DOME / THE JOHN MADJESKI GARDEN

Reception

18.30 – 20.30	£8,000
18.30 – 21.30	£9,000
18.30 – 22.30	£10,000

Dinner

18.30 – 23.00	£11,000
18.30 – midnight	£12,500

Dinner/Dance

18.30 – midnight	£13,000
18.30 – 1.00	£15,000
18.30 – 2.00	£17,000

MEDIEVAL & RENAISSANCE GALLERIES

Reception

18.30 – 20.30	£8,500
18.30 – 21.30	£9,500

Dinner

19.00 – 23.00	£11,000
---------------------	---------

RAPHAEL GALLERY

Reception

19.00 – 21.30	£10,000
---------------------	---------

Dinner

19.00 – 23.00	£14,000
<i>Followed by dancing in the Dome until midnight</i>	<i>£16,000</i>
19.00 – midnight <i>Followed by dancing in the Dome until 1am</i>	<i>£18,000</i>

FASHION GALLERIES

Reception

18.30 – 20.30	£8,500
18.30 – 21.30	£9,500

DOROTHY & MICHAEL HINTZE SCULPTURE GALLERIES

Reception

18.30 – 20.30	£8,000
18.30 – 21.30	£9,000
18.30 – 22.30	£10,000

Dinner

19.00 – 23.00	£11,000
---------------------	---------

MORRIS AND GAMBLE ROOMS

Morris Room Breakfast

8.00 – 9.30	£2,000
-------------------	--------

Gamble Room Breakfast

8.00 – 9.30	£2,500
-------------------	--------

WHITELEY SILVER GALLERIES OR EDWIN AND SUSAN DAVIES PAINTINGS GALLERIES

Reception

18.30 – 20.30	£7,000
18.30 – 21.30	£8,000

THE LYDIA AND MANFRED GORVY LECTURE THEATRE

*Can be combined with
an evening reception*

Full day (no catering possible)

10.00 – 17.30	£4,000
---------------------	--------

Half day (no catering possible)

10.00 – 13.30	£2,000
---------------------	--------

Evening

Hourly rate	£4,000
-------------------	--------

THE SACKLER CENTRE FOR ARTS EDUCATION

THE HOCHHAUSER AUDITORIUM

Full day 10.00 – 17.30...	£3,000
---------------------------	--------

Half day	£1,700
----------------	--------

Evening from	£4,000
--------------------	--------

SEMINAR ROOM 1

Full day 10.00 – 17.30 ..	£2,000
---------------------------	--------

Half day	£1,200
----------------	--------

SEMINAR ROOM 2

Full day 10.00 – 17.30....	£800
----------------------------	------

Half day	£500
----------------	------

SACKLER CENTRE FOYER

18.30 – 21.00	£4,000
---------------------	--------

FURTHER INFORMATION

V&A exhibitions can be hired for an exclusive viewing for an additional £1,000.

Extensions from 11pm are possible for £1,500 per hour thereafter.

Late licences are available until 2am.

The fee for entertainers' dressing room (using the Art Studio) is £500.

Our fees are subject to VAT and there is a supplement for weekend or bank holiday hire.

APPROVED CATERERS

ALISON PRICE & COMPANY

Paul Jackson
Norfolk House
5a Cranmer Road
London SW9 6EJ
T 020 7840 7640
E enquiries@alisonprice.co.uk
www.alisonprice.co.uk

BENUGO HOSPITALITY (V&A IN-HOUSE)

Zib Ndiweni
Victoria and Albert Museum
South Kensington
London SW7 2RL
T 020 7942 2750
E v&aevents@benugo.com
www.benugo.com

BY WORD OF MOUTH LTD

Justin Tinne
22 Glenville Mews
Kimber Road
London SW18 4NJ
T 020 8871 9566
E office@bywordofmouth.co.uk
www.bywordofmouth.co.uk

BLUE STRAWBERRY

Alyson Slater
OPB House
26/28 Sidney Road
London SW9 0TS
T 020 7326 5742
E alyson@bluestrawberry.co.uk
www.bluestrawberry.co.uk

CREATE FOOD & PARTY DESIGN

Matilda Noble
24 Endeavour Way
London SW19 8UH
T 020 8944 4900
E info@createfood.co.uk
www.createfood.co.uk

INN OR OUT

Matt Garrett
Unit 6 Discovery Business Park
St James's Road
London SE16 4RA
T 020 7232 5816
E matt@inn-or-out.com
www.inn-or-out.com

JACKSON GILMOUR

Francis O'Hagan
Unit 12 The Tramsheds
Coomber Way
Croydon CR0 4TQ
T 020 8665 1855
E francis@jacksongilmour.com
www.jacksongilmour.com

MOVING VENUE

Charlie Hepworth
Unit 10 Deptford Trading Estate
Blackhorse Road
London SE8 5HY
T 020 8691 6661
E charlie@movingvenue.com
www.movingvenue.com

MUSTARD CATERING LTD

James Hurworth/Robert Salter
38 Weir Road
London SW19 8UG
T 020 8971 7800
E sales@mustardcatering.co.uk
www.mustardcatering.com

PAYNE AND GUNTER

Jayne Denny
Parkview
82 Oxford Road
Uxbridge UB8 1UX
T 0870 850 1848
E sales@payneandgunter.co.uk
www.payneandgunter.co.uk

ROCKET FOOD LIMITED

Michael Symonds
Unit 5 South Side Industrial Estate
Havelock Terrace
London SW8 4AH
T 020 7622 2320
E parties@rocketfood.net
www.rocketfood.net

THE RECIPE

David Wolanski
Unit A South Studio
Gainsborough Studios
1 Poole Street
London N1 5EE
T 08451 308 087
E david@the-recipe.co.uk
www.the-recipe.co.uk

ZAFFERANO

Joanna Moody
16 Kingsbury Trading Estate
Barningham Way
London NW9 8AU
T 020 8905 9120
E joanna@zafferano.co.uk
www.zafferano.co.uk

APPROVED CONTRACTORS

LIGHTING/PRODUCTION

EVENT CONCEPT

Kirsteen Martin

Units B3 & B4
Galleywall Road Trading Estate
London SE16 3PB
T 020 7740 3988
E info@eventconcept.co.uk
www.eventconcept.co.uk

FISHER PRODUCTIONS LTD

Jason Down

118 Garratt Lane
London SW18 4DJ
T 020 8871 1978
E enquiries@fisherproductions.co.uk
www.fisherproductions.co.uk

FOCUS LIGHTING & PRODUCTIONS LTD

Dom Watson

17 Deer Park Road
Wimbledon
London SW19 3QG
T 020 8542 9221
E dom@focuslighting.co.uk
www.focuslighting.co.uk

WHITE LIGHT LIMITED

Phil Gladman

20 Merton Industrial Park
Jubilee Way
Wimbledon
London SW19 3WL
T 020 8254 4870
E production@whitelight.ltd.uk
www.whitelight.ltd.uk

WISE PRODUCTIONS

Scott Halls

4 Silver Road
White City
London W12 7SG
T 020 8743 1122
E scott@wiseproductions.co.uk
www.wiseproductions.co.uk

SOUND

DOBSON SOUND PRODUCTIONS

Richard Mortimer

17 Deer Park Road
London
SW19 3QG
T 020 8545 0202
E richardmortimer@dobsonsound.co.uk
www.dobsonsound.co.uk

SOUND BY DESIGN LTD

Emma Gallagher

Unit C, Imber Court Trading Estate
Orchard Lane
East Molesey
Surrey KT8 0BY
T 020 8339 3888
E emma@soundbydesign.net
www.soundbydesign.net

PHOTOGRAPHY

JOANNA PLUMBE PHOTOGRAPHY

Joanna Plumbe

Byrons
Dippenhall Street
Crandall
Farnham
Surrey GU10 5PE
T 07831 106443
E joanna@plumbephotography.co.uk
www.plumbephotography.co.uk

APPROVED CONTRACTORS

FLOWERS

DETTA PHILLIPS FLORAL DESIGN

Emma Harvey
274 - 276 Queenstown Road
London SW8 4LP
T 020 7498 2728
E info@dettaphillips.com
www.dettaphillips.com

LAVENDER GREEN FLOWERS

Babs Barnes
17 - 18 Bridgewater Way
Windsor
Berkshire SL4 1RL
T 020 7127 5303
E info@lavendergreen.co.uk
www.lavendergreen.co.uk

SIMON J LYCETT LTD

Simon Lycett
Arch 272
Bethwin Road
London SE5 0YW
T 020 7277 3322
E enquiries@simonlycett.co.uk
www.simonlycett.co.uk

VEEVERS CARTER

Tabitha Allen
Units B3 & B4
Galleywall Road Trading Estate
Bermondsey
London SE16 3PB
T 020 7237 8800
E info@veeverscarter.com
www.veeverscarter.com

MUSIC/ENTERTAINMENT

MUSIC BY ARRANGEMENT

Sarah Balfour
Ground Floor
47 Templars Avenue
London NW11 0NU
T 020 8209 3430
E sarah@mbaevents.co.uk
www.musicbyarrangement.com

PRELUDE

Gemma Robinson
Suite 3, Ground Floor
Nimax House
20 Ullswater Crescent
Coulsdon
Surrey CR5 2HR
T 020 8660 6647
E sales@preludeentertainment.co.uk
www.preludeentertainment.co.uk

PRIVATE DRAMA EVENTS

Adam Blackwood
Unit 2G
Woodstock Studios
36 Woodstock Grove
London W12 8LE
T 020 8749 0987
E adam@privatedrama.com
www.privatedrama.com

STERNBERG CLARKE

Adam Sternberg
Russell House
Spencer Court
140 Wandsworth High Street
London SW18 4JJ
T 020 8877 1102
E adam@sternbergclarke.co.uk
www.sternbergclarke.co.uk



CONTACT INFORMATION

TO BOOK AN EVENT

To book or for more information, please contact:

Corporate Events office
+44 (0)20 7942 2888
corporateevents@vam.ac.uk

www.vam.ac.uk/corporateevents

CORPORATE MEMBERSHIP

V&A Corporate Members enjoy a special association with the Museum. The numerous benefits include complimentary and discounted hire of our spectacular event spaces as well as privileged access to our curators and exhibitions.

For more information, please contact:

Corporate Partnership office
+44 (0)20 7942 2151
s.hargroves@vam.ac.uk

Victoria and Albert Museum
South Kensington
London
SW7 2RL